

Aeromechanical Systems > Towed Targets

Model RM-30A1 Reeling Machine-Launcher

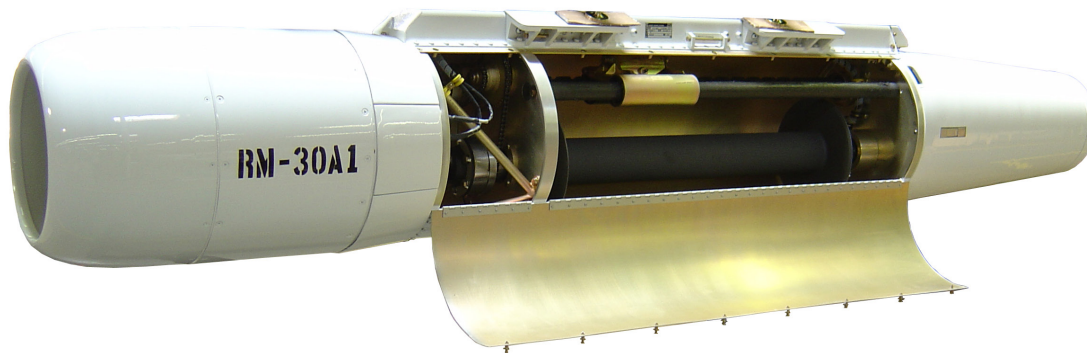

The RM-30A1 represents the state-of-the-art in high performance reeling machine equipment. The primary feature of the RM-30A1 over Meggitt's original RM-30A machine is the complete elimination of all pneumatic and hydraulic systems. The RM-30A1 operates exclusively on electric power and remains compatible with all aircraft on which the original RM-30A system has been qualified. This improved machine is even simpler to maintain than its predecessor and retains all of the original machine's automatic reeling functions, enabling the tow aircraft pilot to operate this machine with minimal interference to his normal cockpit workload. The RM-30A1 control panel provides a selectable digital display of towline length and tension.

The spool can hold up to 9,450 meters (31,000 ft) of towline depending on the target configuration being towed, mission safety requirements, and towline size. The RM-30A1, RM-30A, and its derivative, the RMK-35 (AGTS-36), are currently in use by many of the military forces of the world, including the United States, Japan, Korea and England. These machines are readily adaptable and certifiable with other tow aircraft.

Key features

- Two-way reeling system, permitting recovery and reuse of tow targets
- In use with Gulfstream G-100, Learjet 35 & 36, Falcon 20, Alpha jet, L-59 and Hawker Hunter aircraft
- Microprocessor Logic Control Module (MLCM) provides dependable "user defined" system control and features automatic, power-up self-test of the RM-30A1
- Redundant towline cutters
- Compatible with NATO standard ejector rack lug spacing
- Available with left, right or centerline mounted saddle launcher enabling easy configuration to meet differing aircraft needs with respect to ground clearance and aircraft features
- Optional video kit available to monitor target recovery
- Qualified for worldwide use IAW US Military Specifications and Standards

Meggitt Defense Systems

Our product competencies and services:

Ammunition Handling Systems | Thermal Management | Countermeasures | Towed Targets | Electronic Systems

MEGGITT
smart engineering for
extreme environments

Aeromechanical Systems > Towed Targets

Model RM-30A1 Reeling Machine-Launcher

Specifications

Performance

Reeling	
Tow aircraft speed	(MAX) 250 KCAS
Average towline speed typically	1600 - 2000 FPM
Final recovery speed typically	180 FPM
Maximum Towing Load	3500 LBS

Electrical

Operating Voltage	28 DC
Current (MAX Reeling)	10 AMPS
Recommend Circuit Rating	20 AMPS

Mechanical

Suspension Lugs	14.0 Spacing MS3314 30.0 Spacing MK 3 MOD 0
Usable Towline Volume	2250 IN ³
Nominal Weight	510 lbs (including launcher, less towline)

External launcher

Height	6.5 IN
Length	48.5 IN
Width	5.5 IN
Cutter Cartridge	MK 23 MOD 0

Cockpit control pit

Height	2.63 IN
Length	6.50 IN
Width	5.75 IN
Weight	2.1 LB
Operating Voltage	28 DC
Current	1 AMP

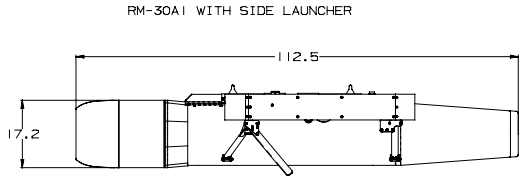
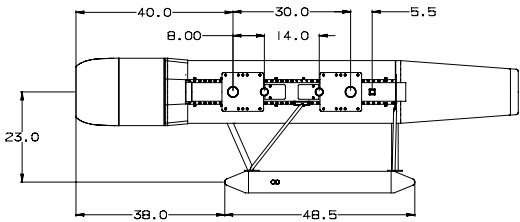

Specification subject to change - TCO Review #XXX



Contact

Meggitt Defense Systems

9801 Muirlands Blvd
Irvine, CA 92618, USA
Tel: +1 (949) 465 7700
Fax: +1 (949) 465 9560

www.meggittdefense.com
www.meggitt.com